

# Strainer, DN 17

# Product Information



**A.u.K. Müller**

Solenoid valves  
Control valves  
Special valves and systems

A. u. K. Müller GmbH & Co. KG  
Dresdener Str. 162  
D-40595 Düsseldorf/Germany

Tel.: +49(0)211-7391-0  
Fax: +49(0)211-7391-281

e-mail: info@akmueller.de  
Internet: www.akmueller.de

## Series 12.017.400 /~.500



12.017.400



12.017.500

## Characteristics

- replaceable filter elements, easy to clean
- easy to assemble
- high flow rate
- medium temperature up to 90 °C
- operating pressure up to 10 bar
- various connections available

## Available approvals

- KTW-BWGL System 1+
- SVGW
- WRAS
- NSF 169
- others on request

## Applications

- for protection of ...
- solenoid valves
  - sanitary fittings
  - flow meters
  - check valves
  - instantaneous water heaters

## Description

The upstream mounted strainer will protect taps and other equipment against damages or malfunctions caused by suspended particles. The treatment of drinking water by the use of mechanical acting filters and their design is regulated in DIN EN 13443.

There is no need to disassemble the strainer nor tool to replace the filter insert. It is recommended to mount the strainer with the filter insert preferably downwards, to avoid that collected dirt remains in the housing, during replacement of the insert.

Type 12.017.400 is intended to be used for applications, in which valves, ball valves or others are already installed for use as shut off devices during replacement of insert.

Type 12.017.500 integrates a shut off flow capability. The strainer is forcibly closed and an upstream shut off device is not required.



Typical Performance Curve

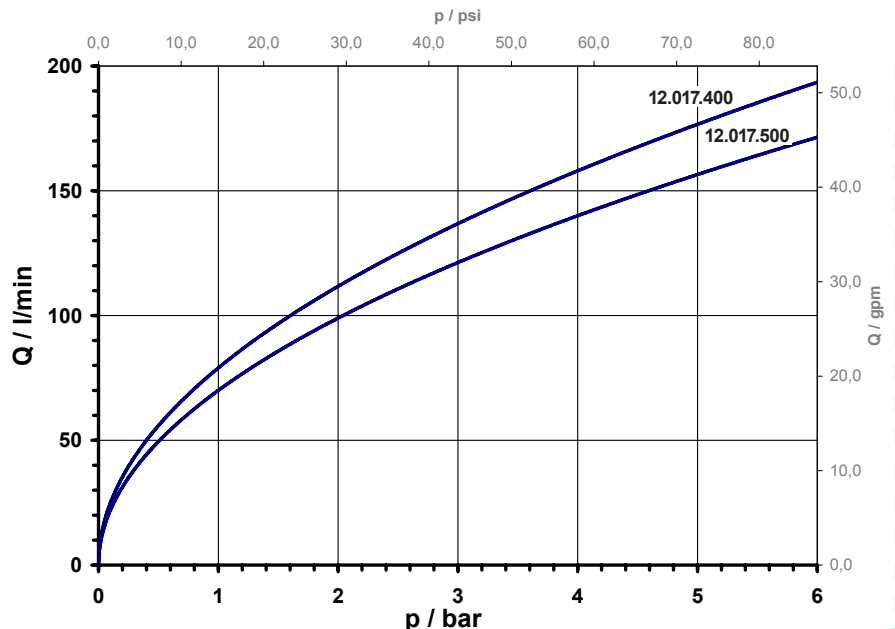



**Series 12.017.400 / ~.500**

**Assembly Instruction for Swivel Nuts**

In order to avoid damage to the swivel nuts or leaks in the screw connections, please follow these assembly instructions.

- Place the swivel nut straight onto the thread of the male counterpart.
- Make sure that the metal ring is well seated in the area of the toothing.
- Tighten the swivel nut to a torque of 3 Nm.
- Check the installation for leaks.
- Repeat the leakage check at suitable intervals.
- Only use original seals and spare parts from A. u. K. Müller.

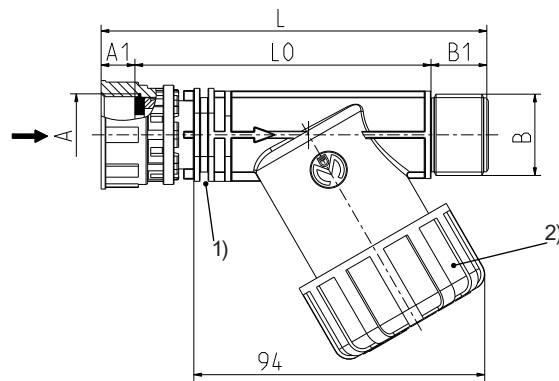
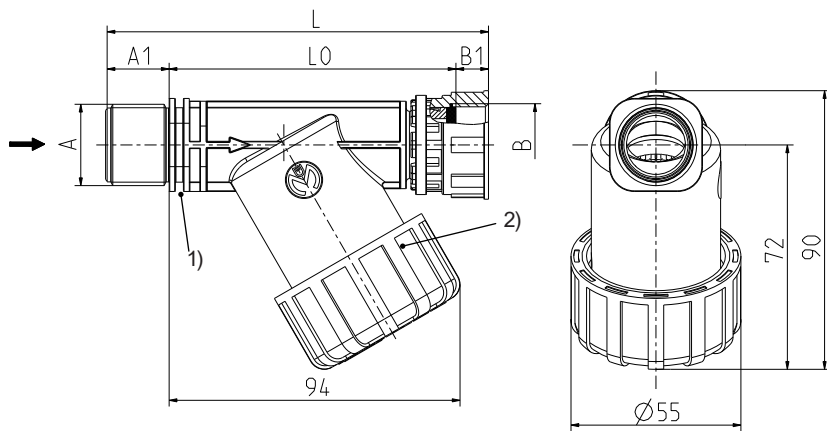

**12.017.400**  
no shut off capability

- 1) Groove for flange
- 2) Screw Cap

Screw on with a tightening torque of up to 2 Nm up to the stop. Then turn 15° to 20° in the opposite direction to the left.

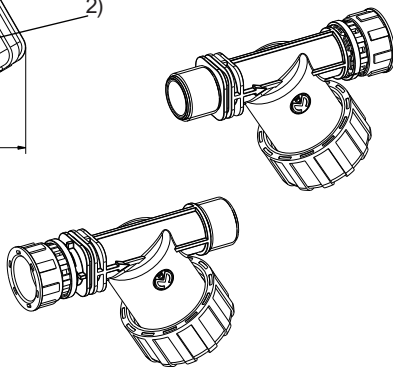

**Options**

Inlet*	A1	Outlet*	B1	L0	Length	L
G 3/4	20,0	G 3/4 swivel nut	10,5	92,5	123,0	
G 3/4 swivel nut	11,0	G 3/4	18,0	95,5	124,5	
G 3/4	20,0	G 3/4	18,0	76,5	114,5	
G 3/4 swivel nut	11,0	G 3/4 swivel nut	10,5	111,5	133,0	on request

\* Every connector combination for inlet and outlet is possible on request.

**Technical Data**

Type	strainer	
Construction	mechanical filter	
Fitting position	preferably filter element pointing downwards	
Media	cold and heated potable water and physically and chemically similar media	
T-Medium	5 - 90	°C
DN	17	mm
p-Operating	10	bar max.
Admissible pressure loss	6	bar max.
Flow Factor Kv		
12.017.400	79	l/min
12.017.500	70	l/min

**Materials**

Body / inner parts	PA66, PA 6/6, others on request/ stainless steel
Seals	EPDM
Filter	stainless steel PA 66
Mesh size / wire diameter	0,11 mm / Ø 0,06 mm 0,25 mm / Ø 0,10 mm

		filter inserts
Mesh size / wire diameter	0,11 mm / 0,06 mm ID: 006506 Cold water	
Part number	0,25 mm / 0,10 mm ID: 009486 Cold and Hot water	



**Series 12.017.400 /~.500**

**12.017.500**

includes shut off capability

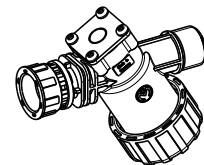
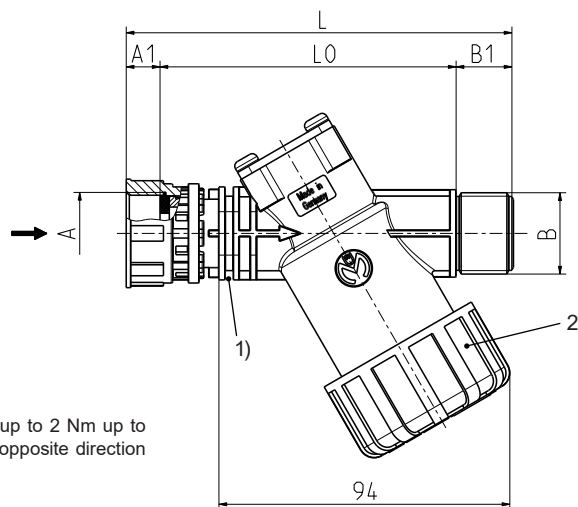
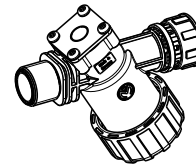
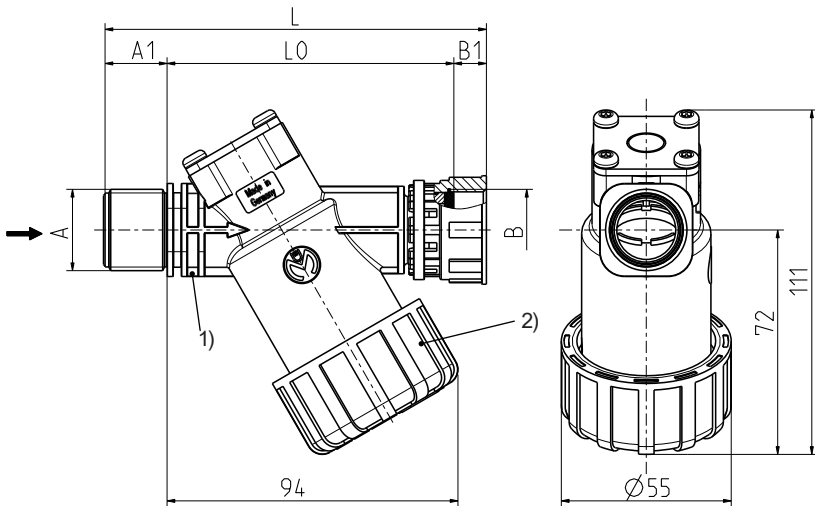

- 1) Groove for flange
- 2) Screw Cap

Screw on with a tightening torque of up to 2 Nm up to the stop. Then turn 15° to 20° in the opposite direction to the left.

Options					
Inlet*		Outlet*		Length	
Ø A	A1	Ø B	B1	L0	L
G 3/4	20,0	G 3/4 swivel nut	10,5	92,5	123,0
G 3/4 swivel nut	11,0	G 3/4	18,0	95,5	124,5
.75 - 11.5 NH swivel nut	11,0	G 3/4	18,0	95,5	124,5

\* Every connector combination for inlet and outlet is possible on request.



Series 12.017.400 /~.500

**12.017.500**  
includes shut off capability

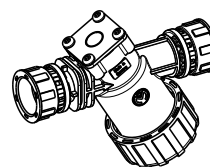
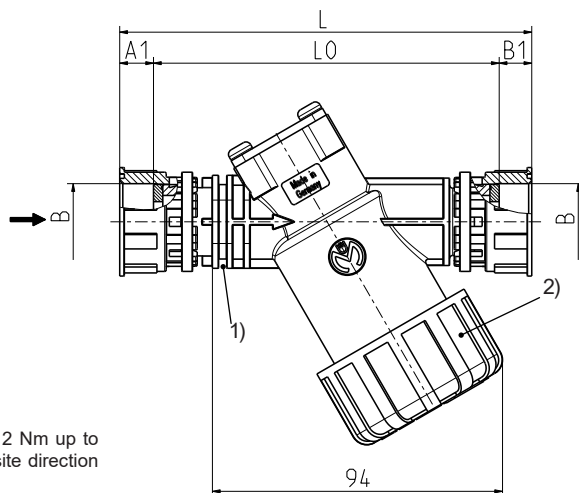
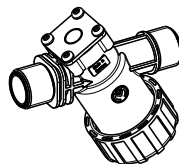
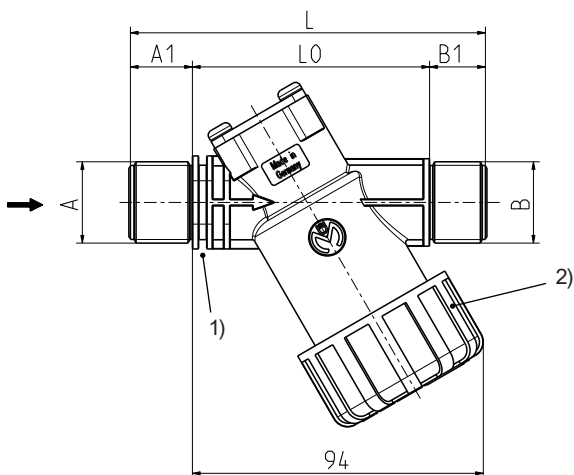

- 1) Groove for flange
- 2) Screw Cap  
Screw on with a tightening torque of up to 2 Nm up to the stop. Then turn 15° to 20° in the opposite direction to the left.

Options						
Inlet*		Outlet*		Length		
Ø A	A1	Ø B	B1	L0	L	
G 3/4	20,0	G 3/4	18,0	76,5	114,5	on request
G 3/4 swivel nut	11,0	G 3/4 swivel nut	10,5	111,5	133,0	on request

\* Every connector combination for inlet and outlet is possible on request.

### Warning Notice

Before working on the valve, carefully observe the following warning notice.

**! ATTENTION !**

Danger of scalding from escaping hot water!

Observe the following points for safe handling of the valve:

- Make sure that your pipe system is pressureless.
- Please note that there may still be hot residual water in the valve and in the connected pipe system.
- Only open the valve when there is sufficient cooling time if you operate your system in hot water.
- After closing the valve, carefully check for escaping water.