

# Product Information

## Back-suction Safe Float Valve, NC, DNI10 Two Chambers in a Row



**A. u. K. Müller**

Solenoid valves  
Control valves  
Special valves and systems

A. u. K. Müller GmbH & Co. KG  
Dresdener Str. 162  
D-40595 Düsseldorf/Germany

Tel.: +49(0)211-7391-0  
Fax: +49(0)211-7391-281

e-mail: [info@akmueller.de](mailto:info@akmueller.de)  
Internet: [www.akmueller.de](http://www.akmueller.de)

**Series 21.010.726**



### Characteristics

- Back-suction proof according to British Standard 1212-4:2016 Annex E
- Proportional behavior (flow rate depends on float lever position)
- Adjustable float
- For heated water up to 90 °C without KIWA approval possible on request
- High functional reliability due to the use of high-quality materials and 100% final product testing
- Long term performance capability
- Compact design

### Patented technology

#### Description

In industrial applications, containers are usually kept at a constant filling level by using float valves.

Valves of this design are 2-chamber globe valves and have an additional back flow preventer to provide additional protection against backsiphonage of service water into the drinking water network in accordance with DIN 1717. In addition to the extra safety, this also enables KIWA-compliant use. The valves can be manufactured with different housing connections.

The valve in the chamber on the outlet side regulates the inflow via the float lever. A sealing element in the chamber on the inlet side prevents back-suction from the tank into the inlet pipe.

If the liquid level in the tank drops, the float valve automatically replenishes and thus keeps the level constant.

If the water level rises and lifts the float in the tank, the inflow will get reduced in proportion to the position of the float lever. Overflowing of the tank as a result of excessive inflow during initial filling of the tank is effectively prevented.

#### Applications

- Irrigation systems
- Industrial appliances
- Air conditioning
- Cleaning systems
- Washing systems
- Water purification installations
- Dishwashers
- Washing machines

#### Approvals



- KIWA Reg. 4
- Others on request

Typical Performance Curve  
(measured under laboratory conditions)

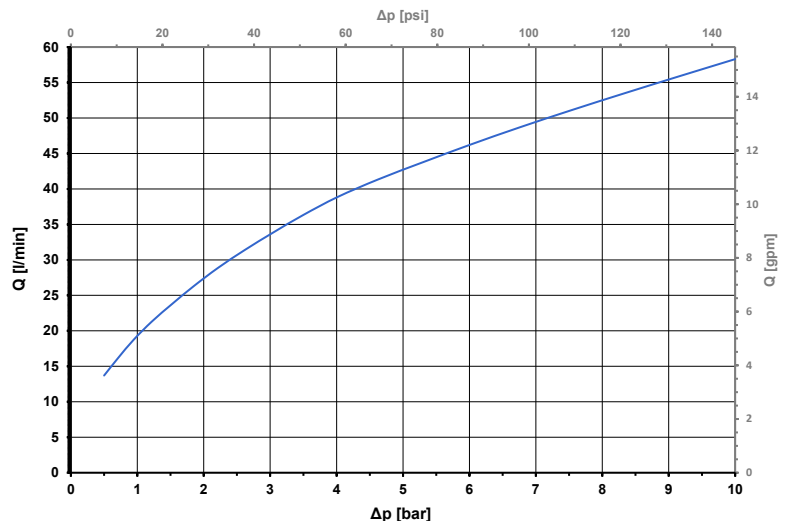

# Product Information

## Back-suction Safe Float Valve, NC, DN10 Two Chambers in a Row



A. u. K. Müller

### Series 21.010.726

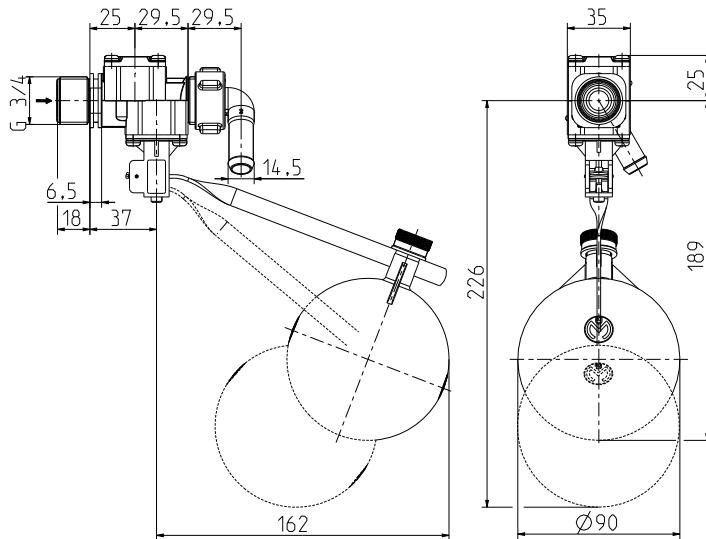

### Technical Data

<b>Type</b>	float valve
<b>Construction</b>	2/2-way, 2-chamber straight valve, servo-controlled
<b>Function</b>	closes by float lift, back suction safe
<b>Fitting position</b>	float vertically downwards
<b>Media</b>	cold and heated potable water as well as physically and chemically similar media
<b>T-Medium</b>	5 - 23 °C with reg. 4 5 - 90 °C without reg. 4
<b>T-Ambient</b>	see T-Medium
<b>DN</b>	10 mm
<b>p-Operating</b>	0,2 - 8 bar
<b>Flow factor Kv</b>	19 l/min
<b>Flow regulator</b>	on request, see product data sheet MR
<b>Float body</b>	adjustable position

### Materials

<b>Valve body</b>	PA 66 glass fibre reinforced
<b>Metal parts in medium</b>	stainless steel
<b>Membrane and sealings</b>	EPDM
<b>Float body</b>	HDPE, stainless steel (1.4301 on request)
<b>Float lever</b>	Brass CW508L 10x2
<b>Dirt strainer (in the inlet)</b>	POM stainless steel (on request)

